

---

# ULTIMATE LOAD

---



CLIENT - ALUMINIUM BALUSTRADES NORTH COAST

PRODUCT - STUCTGLASS 1500 MM

TESTED BY  
AZUMA DESIGN PTY LTD

AZT0492.17

This document shall not be reproduced, except in full.

# 1 Aim

To determine the breaking force of the test specimen.

## 2 Test Sample Information

Product Name/Number	StructGlass 1500 mm Panel
Customer	Aluminium Balustrades North Coast
Azuma Test Number	AZT0492.17
Date	01/12/2017
Test Force Direction	Horizontal load across top edge of panel
Test Constraints	Uniformly spread along top edge
Material	Aluminium Posts, Toughened Laminated Glass (5/1.52/5 mm)

## 3 Testing

### 3.1 Procedure

The following method is applied to the test specimen:

1. The test specimen was set up and clamped to the floor
2. The force was then applied to top edge of the panel
3. The force was increased until breakage occurred
4. The force is recorded and the damage to the test specimen noted

### 3.2 Results

Product	
Force Reached Before Breakage	7430 N
Significant bend in posts glass remained unbroken, could not exceed the above figure. A final push took place in which the spreader bar flicked off and the ram touched the glass causing it to crack but still be retained within the posts, the force did not increase.	



### 3.3 Pictures

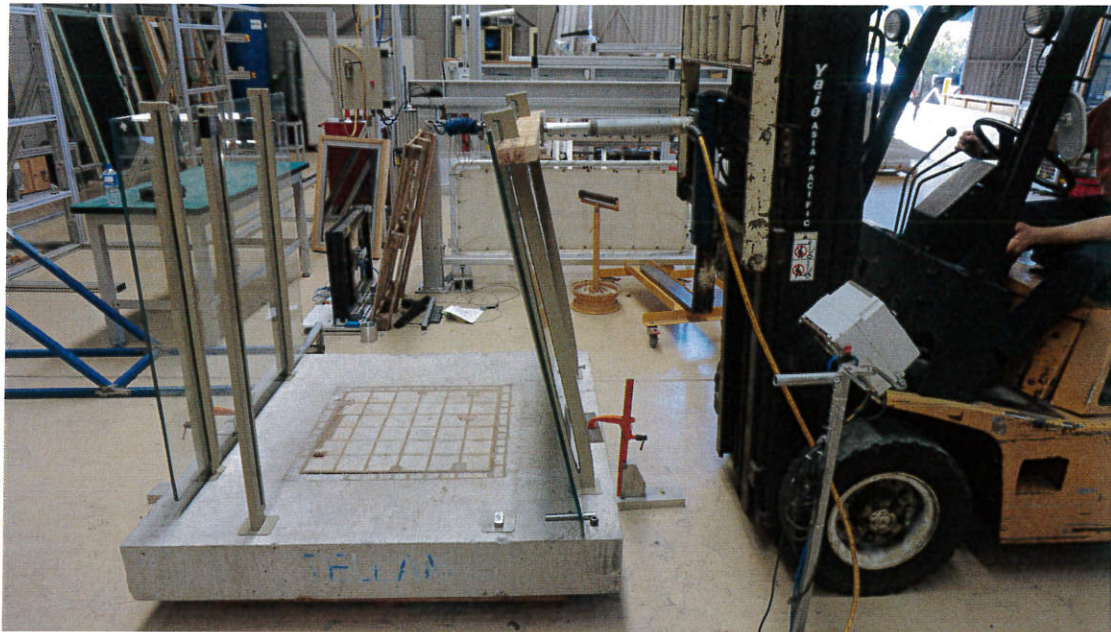

Figure 1: Sample at 7430 N



Figure 2: Force Readout

AZT 0492.17

Azuma Design PTY LTD  
38 Redfern Street Wetherill Park, NSW, 2164 Australia +61(02) 9604 0255  
Accreditation Number : 15147  
Accredited for compliance with ISO/IEC 17025.







Figure 3: Sample with gap between the clamps

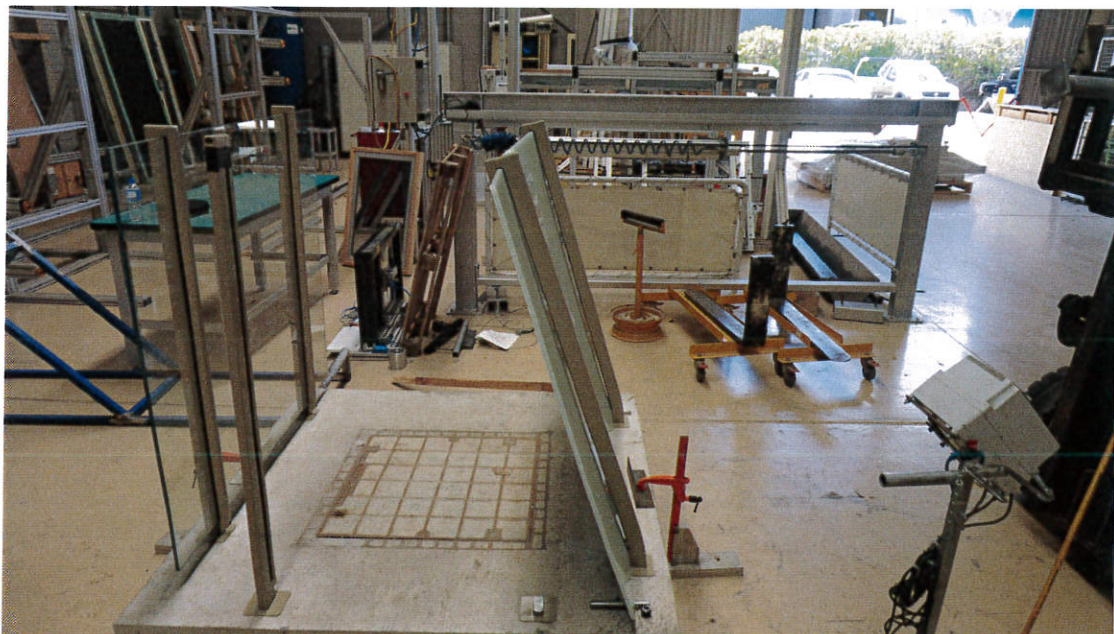

Figure 4: Sample after forklift ram



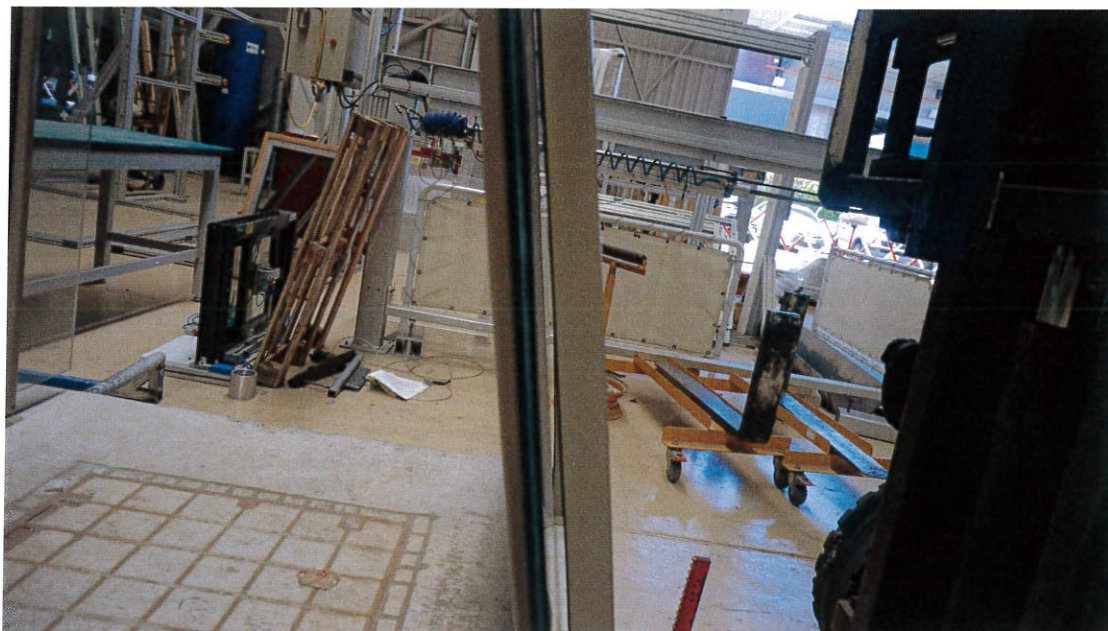

Figure 5: Sample with gap between the clamps after forklift ram



Figure 6: Sample after forklift ram - broken glass caused by hydraulic ram

## 4 Signatories

Tested By: Ash Horne

Signature: Ash Horne

Date: 01/12/2017

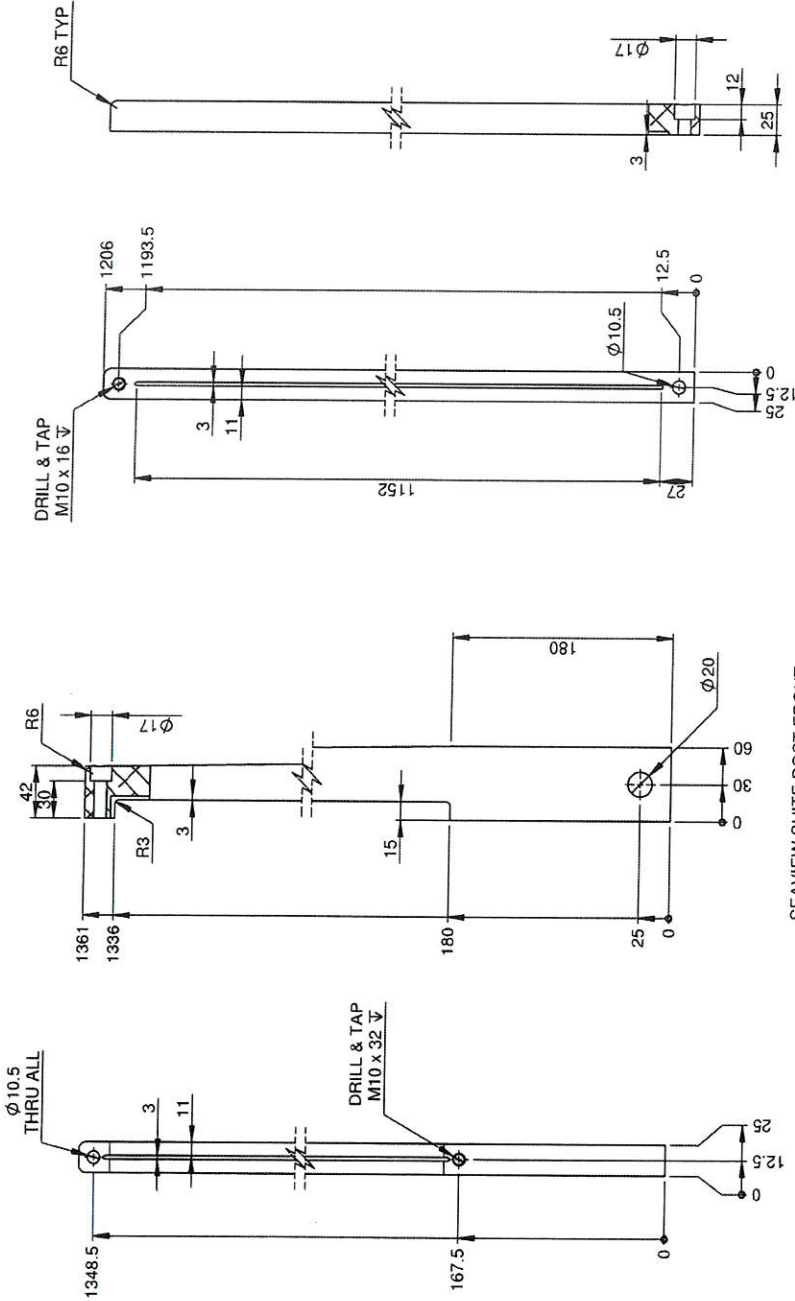
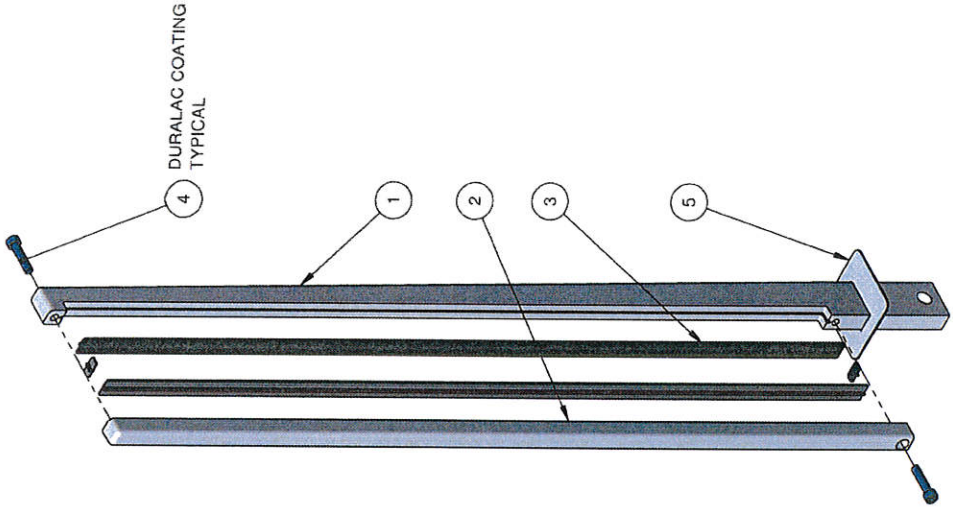

SEAVIEW SUITE POST BACK

SEAVIEW SUITE POST FRONT

SEAVIEW SUITE POST ASSEMBLY  
EXPLODED VIEW

ITEM	PART NAME	MATERIAL	LENGTH	QTY
1	SEAVIEW SUITE POST FRONT	25MM ALUMINIUM PLATE	60 x 1361	1
2	SEAVIEW SUITE POST BACK	25MM ALUMINIUM PLATE	25 x 1206	1
3	SEAVIEW SUITE POST SEAL	BLACK FLEXIBLE PVC		4
4	SEAVIEW SUITE POST SHCS-M10	STAINLESS STEEL (DURALAC COATING)	45.0	2
5	SEAVIEW SUITE POST COVER PLATE	2MM SHEET	100 x 100	1

© Architectural Metalworks Australia - All Rights Reserved

This drawing is the property of Architectural Metalworks Australia and is to be used for the project only. It is not to be reproduced, copied or used for any other purpose without the written consent of Architectural Metalworks Australia.



PHONE: 617 5493 8333  
WEB: www.abnc.com.au  
EMAIL: admin@abnc.com.au



SEAVIEW SUITE POST COVER PLATE

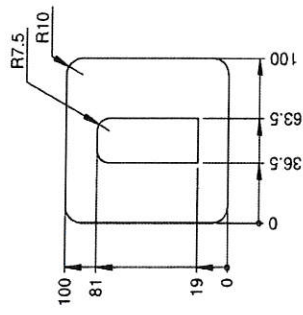

ITEM DESCRIPTION  
GLASS BALUSTRADE  
DWG NO. (PROJECT) - ITEM CODE - LEVEL#  
SEAVIEW SUITE-BAL-  
SHEET  
2 OF 15  
SCALE  
1:6  
REVISION  
A  
A3

CLIENT  
ARCHITECTURAL METALWORKS AUSTRALIA  
SEAVIEW SUITE BALUSTRADE  
SITE ADDRESS  
15 / 17 BEARING AVE  
WARANA  
WEIGHT  
3.5 KGS  
DRAWN  
LD  
27/07/2017



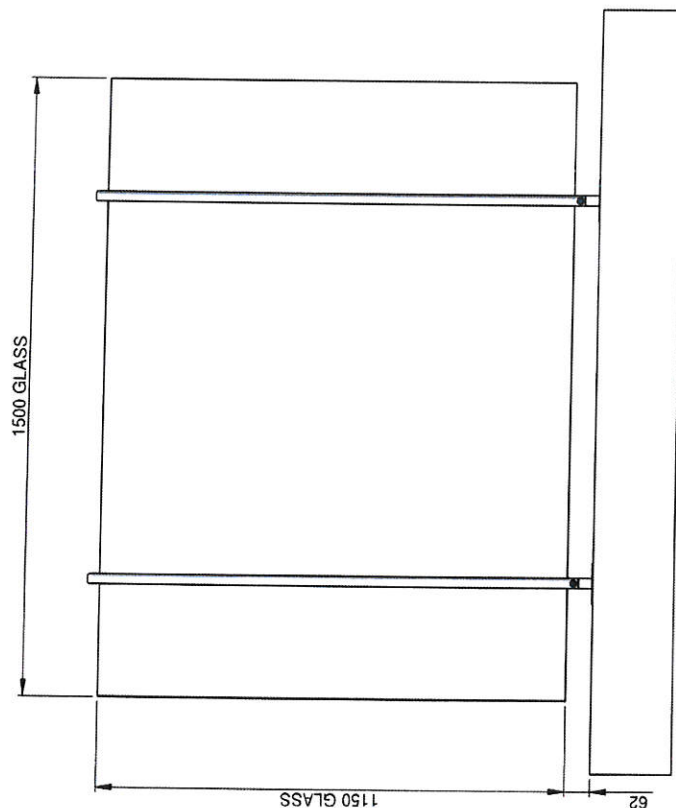
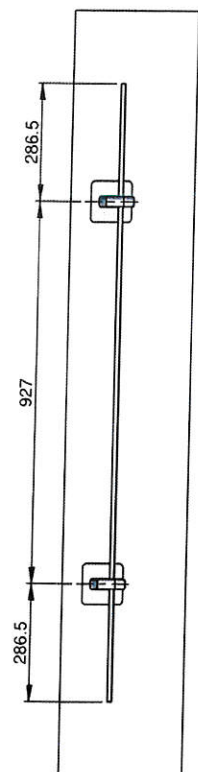

SEAVIEW SUITE - 1500 PANEL

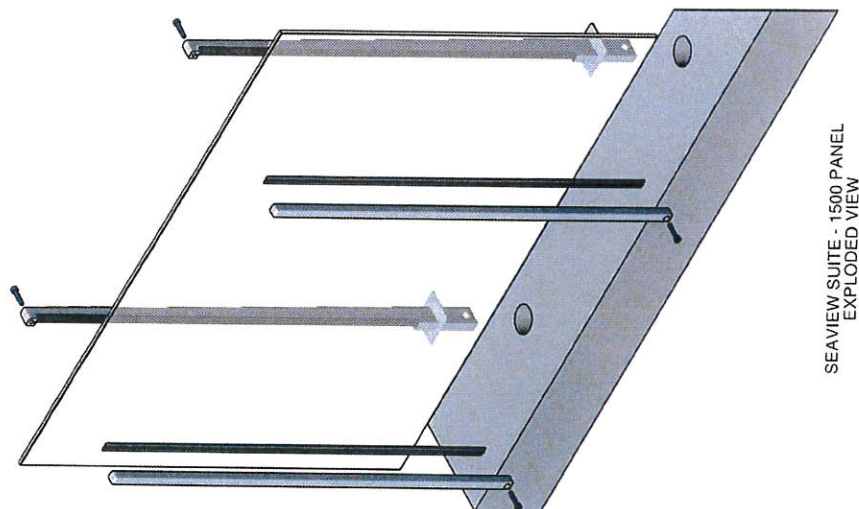
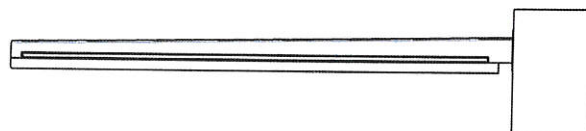

SEAVIEW SUITE - 1500 PANEL  
EXPLODED VIEW



© Architectural Metalworks Australia - All Rights Reserved  
This document is produced by Architectural Metalworks Australia for the use of the client and is not to be used for any other purpose without the written consent of Architectural Metalworks Australia. Any reproduction or use of this document without the written consent of Architectural Metalworks Australia is prohibited. For any person other than the client, this document is provided for their information only and is not to be used for any other purpose without the written consent of Architectural Metalworks Australia.

CLIENT  
ARCHITECTURAL METALWORKS AUSTRALIA  
PROJECT  
SEAVIEW SUITE BALUSTRADE  
SITE ADDRESS  
15 / 17 BEARING AVE  
WARANA

COLOUR  
ITEM DESCRIPTION  
GLASS BALUSTRADE  
DWG NO. PROJECT# - ITEM CODE - LEVEL#  
SEAVIEW SUITE-BAL-

SHEET  
13 OF 15  
SCALE  
1:12  
REVISION  
A  
A3